

STEP 1

Unfold the bottom half of the frame.

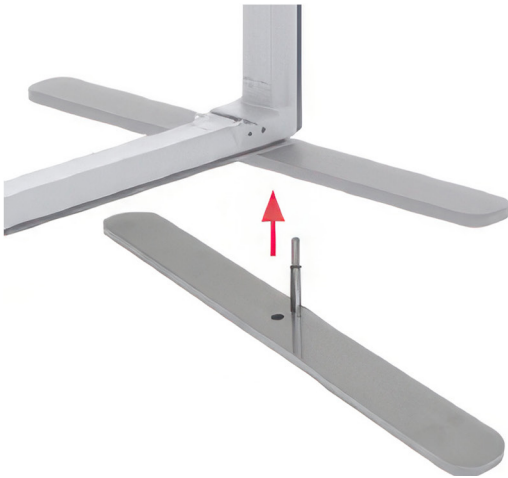

STEP 2

Attach the bottom half of the frame to the feet.

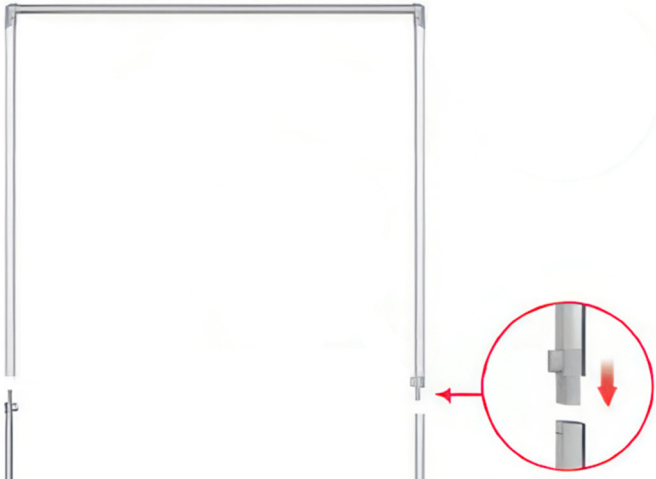

STEP 3

Unfold the top half of the frame and connect the male and female ends of the frame to the bottom half of the frame.

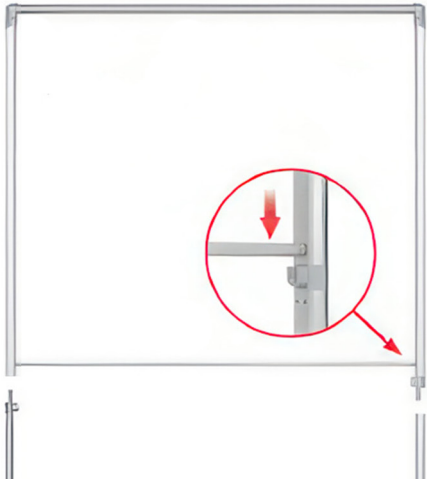

STEP 4

Slide the middle support bar into the frame connector pieces.

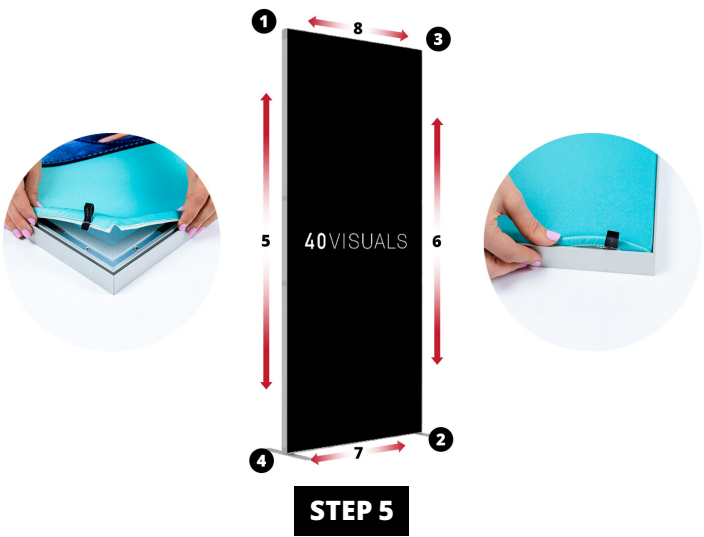

To install the SEG fabric, insert the silicone edge into the outer channel of the hardware. Start at the top left corner then attach to the opposite (bottom right) corner. Repeat for the other two corners. Then insert the silicone edge into the channel in the middle of each side, then finish tucking the rest of the fabric into the channel until the fabric is stretched smooth.

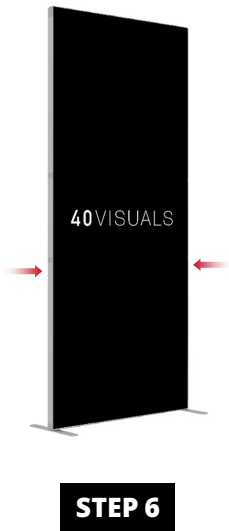

To move the display, pick up below the seam in the vertical profile bars.